

3910 & 3911 Series Dust Proof Strikes

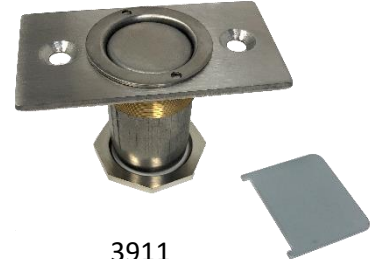

3910
Dust Proof Strike

3910N
No Face Plate



3911
Adjustable Dust Proof Strike

ABOUT THE 3910 & 3911 DUST PROOF STRIKES

The 3910 & 3911 Series are specifically designed for use with the Trimco 3800 Series Automatic and Semi-Automatic Flushbolts, as well as the Trimco Manual Flushbolt assemblies. The 3910 and 3911 Series have a large $\frac{3}{4}$ " diameter target area and a soft spring to aid ADA compliance. For a 3910 with no face plate, specify 3910N. The 3911 Adjustable Dust Proof Strike includes a wrench to twist and adjust the depth of the strike.

FEATURES

- Pairs with Trimco Automatic, Semi-Automatic, and Manual Flushbolts
- Soft Spring to aid ADA compliance
- Durable construction
- Large $\frac{3}{4}$ " diameter target area

APPLICATIONS

- K-12 Schools
- Colleges & Universities
- Healthcare
- Government Facilities
- Public Buildings
- Hospitality

FINISHES

- 605 Polished Brass
- 606 Satin Brass
- 613 Oil Rubbed Bronze
- 625 Polished Chrome
- 626 Satin Chrome
- 629 Polished Stainless Steel
- 630 Satin Stainless Steel
- Inquire for special finishes

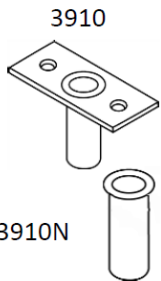

3910N

(No Face Plate)

| TRIMCO# | 3910 | 3910N |
|---------|--------------------------------|-------|
| OA | $3/32"$ x $1-5/16"$ x $2-1/2"$ | |
| DP | $1-1/2"$ | |
| BHMA | L04021 | |

Br, Bz, Pl, SS

Dust Proof Strike

To omit faceplate add suffix "N".

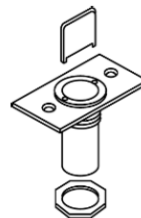

| TRIMCO# | 3911 |
|---------|--------------------------------|
| OA | $3/32"$ x $1-5/16"$ x $1-5/8"$ |
| DP | $1-1/2"$ |
| BHMA | L04021 |

Br, Bz, Pl, SS

Adjustable Dust Proof Strike

For carpet or threshold.