

Retrofit Coverplates

RFCP SERIES

OVERVIEW

Retrofit Cover Plates are used to cover or adapt existing holes or cutouts in a door when retrofitting the door with new hardware. When door hardware is replaced, the new hardware might not fully cover the previous hardware's prep holes. Trimco Retrofit Cover Plates hides these imperfections by providing a clean, finished look by covering holes no longer needed and giving access to holes needed to receive the new hardware.

Retrofit Cover Plates are sold in sets of two, one for the interior and exterior of the entryway.

For custom Retrofit Coverplates, please see the attached Order Form.

Each entryway is unique. Please visit TrimcoHardware.com to confirm the dimensions of the Retrofit Coverplate, including but not limited to overall size, hole pattern, and centerline are appropriate for the application and legacy hardware being removed.

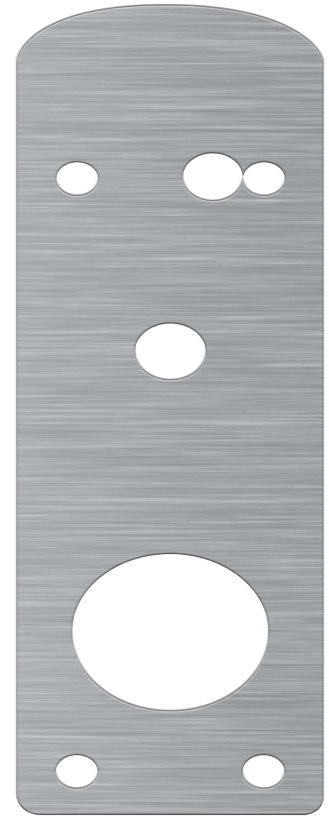

RFCP-CO-CY.630 shown for Schlage CO Series - Cylindrical

HARDWARE MODEL	TEMPLATE #	ITEM #	INTERIOR WIDTH X LENGTH	EXTERIOR WIDTH X LENGTH	2026 List Price (630)
AD SERIES - CYLINDRICAL	AD101, AD102	RFCP-AD-CY	4.5" x 15.5"	4.5" x 10.5"	\$ 62.20
AD SERIES - MORTISE	AD103, AD104	RFCP-AD-MS	4.5" x 15.5"	4.5" x 10.5"	\$ 62.20
CO SERIES - CYLINDRICAL	CO101, CO102, CO201, CO202	RFCP-CO-CY	5" X 14"	5" X 14"	\$ 62.20
CO SERIES - MORTISE	CO103, CO104, CO203, CO204	RFCP-CO-MS	5" X 14"	5" X 14"	\$ 62.20
LE SERIES - ADDISON	LE3, LE4, LE7, LE8	RFCP-LE-ADDISON	4" X 12"	3.5" X 11"	\$ 62.20
LE SERIES - GREENWICH	LE1, LE2, LE5, LE6	RFCP-LE-GREENWICH	4" X 11"	3.5" X 11"	\$ 62.20
ND/NDE SERIES	All Models except NDI70/172, and HSLR	RFCP-ND/NDE	5" X 16"	5" X 16"	\$ 62.20
NDEB SERIES	NDEB1, NDEB2	RFCP-NDEB	4.5" X 8.2"	4.5" X 6"	\$ 62.20
XE360 SERIES - CYLINDRICAL	XE101, XE102	RFCP-XE360-CY	4" X 11"	4" X 11"	\$ 62.20
XE360 SERIES - MORTISE	XE103, XE104	RFCP-XE360-MS	4" X 11"	4" X 11"	\$ 62.20

Finishes



606 Satin Brass



609 Antique Bronze



612E Satin Bronze Equivalent



613E Oil Rubbed Bronze Equivalent



622 Matte Black



629 Bright Stainless Steel



630 Satin Stainless Steel

Retrofit Cover Plates

RFCP SERIES CUSTOM ORDER FORM



CONTACT INFORMATION / DISTRIBUTOR INFORMATION

COMPANY: _____ COMPANY CONTACT: _____
 EMAIL: _____ PHONE: _____ PURCHASING DISTRIBUTOR: _____

PROJECT INFORMATION

PROJECT NAME: _____

PROJECT CITY: _____ PROJECT STATE: _____ PROJECT ZIPCODE: _____

NEW INSTALL HARDWARE INFORMATION

HARDWARE MANUFACTURER: _____ HARDWARE MODEL: _____
 TEMPLATE #: _____

Corners

Rounded **Squared**
.125" Standard



Mounting

No Mounting **Mounting**
Plate mounts from hardware mounting #5 Screw



Notes

Use this section to communicate more about the design, plate shape, etc

INTERIOR INFORMATION

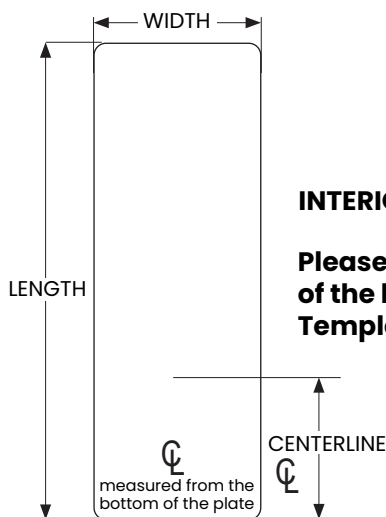

INTERIOR QTY: _____

Please reference the $\text{\textcircled{C}}$ of the hardware from Template #

Dimensions

Length _____ in
 Width _____ in
 $\text{\textcircled{C}}$ _____ in

Corners

Rounded
 Square

Mounting

No
Plate mounts from hardware mounting
 Yes

EXTERIOR INFORMATION

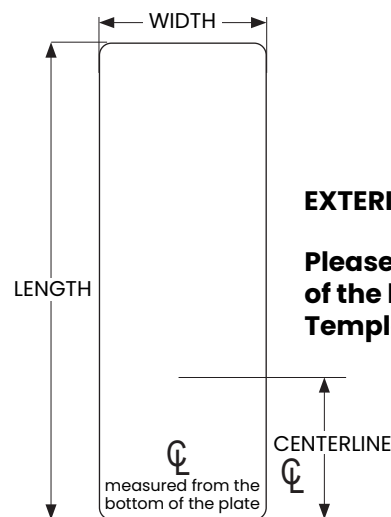

EXTERIOR QTY: _____

Please reference the $\text{\textcircled{C}}$ of the hardware from Template #

Dimensions

Length _____ in
 Width _____ in
 $\text{\textcircled{C}}$ _____ in

Corners

Rounded
 Square

Mounting

No
Plate mounts from hardware mounting
 Yes



Trimco®

SINCE 1949

TRIANGLE BRASS MANUFACTURING
1351 ROCKY POINT DRIVE, OCEANSIDE, CA 92056
WWW.TRIMCOHARDWARE.COM
CSR@TRIMCOHARDWARE.COM
323.262.4191

STEP 1

REMOVE LEGACY HARDWARE

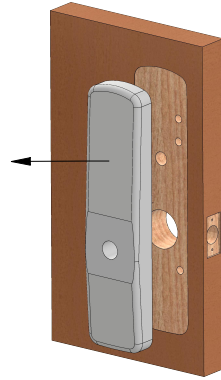

STEP 2

FOR EACH SIDE OF THE DOOR MEASURE THE LENGTH AND WIDTH OF THE IMPERFECTION THAT REQUIRES COVERING. BE MINDFUL EXTRA MATERIAL MAY BE NEEDED TO PROPERLY COVER THE IMPERFECTION.

THE NEW HARDWARE SHOULD REST ON TOP OF THE PLATE. DESIGN THE PLATE LENGTH AND WIDTH WITH THIS IN MIND.

AFTER DETERMINING THE SIZE OF THE PLATE FIND THE LOCATION OF THE CENTERLINE FOR THE NEW HARDWARE ON THE DOOR. PLEASE REFER TO THE NEW HARDWARE TEMPLATE FOR THE CENTERLINE (IT MAY NOT BE A BORE).

MEASURE FROM THE BOTTOM OF THE DESIGNED PLATE TO THE CENTERLINE OF THE NEW HARDWARE.

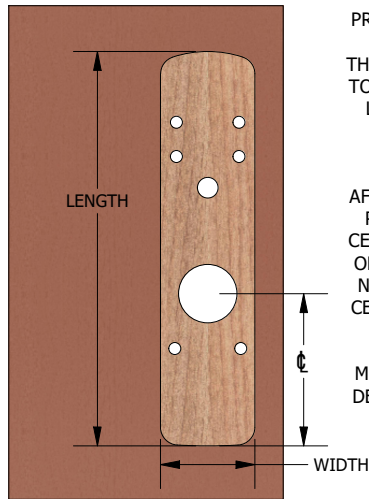

OVERVIEW

RETROFIT COVER PLATE GUIDANCE

THE PURPOSE OF THIS PRODUCT IS TO COVER IMPERFECTIONS FROM LEGACY HARDWARE AND GIVE ACCESS TO HOLES NEEDED TO MOUNT NEW HARDWARE.

STEP 3

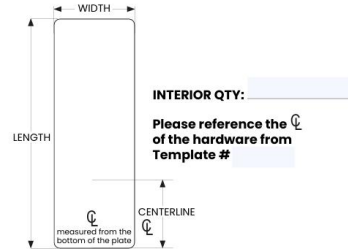

DOCUMENT THE CENTERLINE, OVERALL WIDTH AND LENGTH OF THE RETROFIT COVER PLATE ON THE ORDER FORM OR CONSIDER THESE DIMENSIONS WHEN REVIEWING DIMENSIONS OF A STOCK RETROFIT COVER PLATE.

Dimensions	Corners	Mounting
Length _____ in	<input type="checkbox"/> Rounded	<input type="checkbox"/> No Plate mounts from hardware mounting
Width _____ in	<input type="checkbox"/> Square	<input type="checkbox"/> Yes
Centerline _____ in		

STEP 4

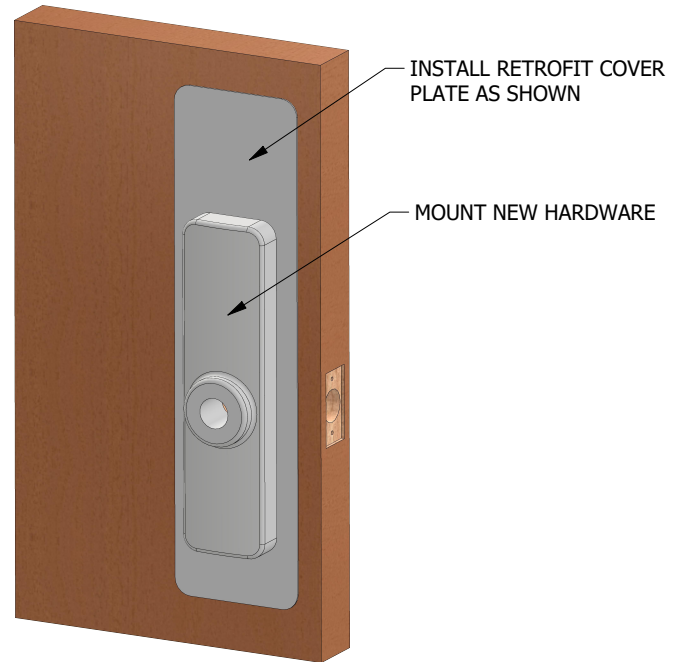

NOTES

EACH ENTRYWAY IS UNIQUE. PLEASE CONFIRM THE DIMENSIONS OF THE RETROFIT COVER PLATE, INCLUDING BUT NOT LIMITED TO OVERALL SIZE, HOLE PATTERN, AND CENTERLINE ARE APPROPRIATE FOR THE APPLICATION AND LEGACY HARDWARE BEING REMOVED.