

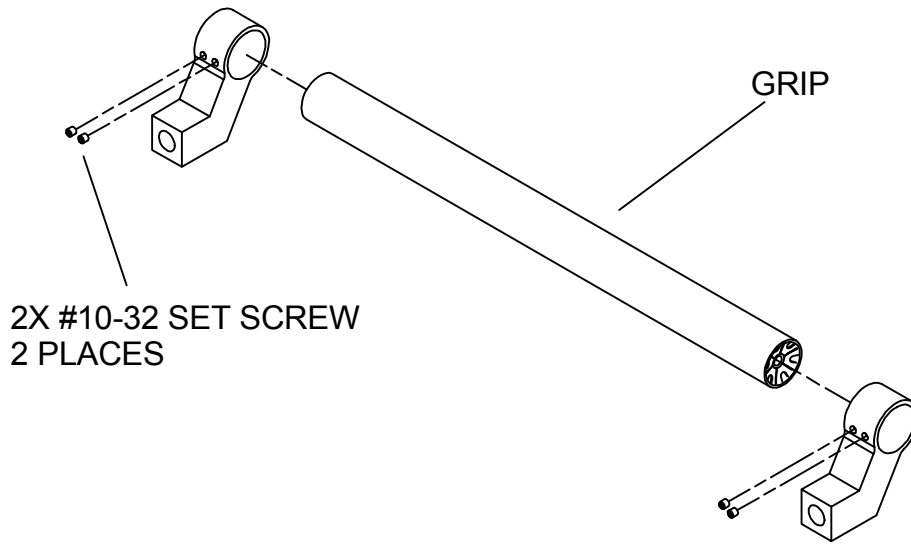

OFFSET STANDOFF/GRIP ASSEMBLY



CONFIGURATION GUIDE:

STEP-BY-STEP PULL ASSEMBLY:

OFFSET STANDOFFS/GRIP &
STRAIGHT STANDOFFS/GRIP
ASSEMBLY: SHEET 1

OFFSET STANDOFFS/GRIP/
END CAP ASSEMBLY &
STRAIGHT STANDOFFS/GRIP/
END CAP ASSEMBLY: SHEET 2

**FINAL INSTALLATION OF
ASSEMBLED PULLS:**

1185 OFFSET STANDOFFS
PULL ASSEMBLY: SHEET 3

1185 STRAIGHT STANDOFFS
PULL ASSEMBLY: SHEET 4

STRAIGHT STANDOFF/GRIP ASSEMBLY

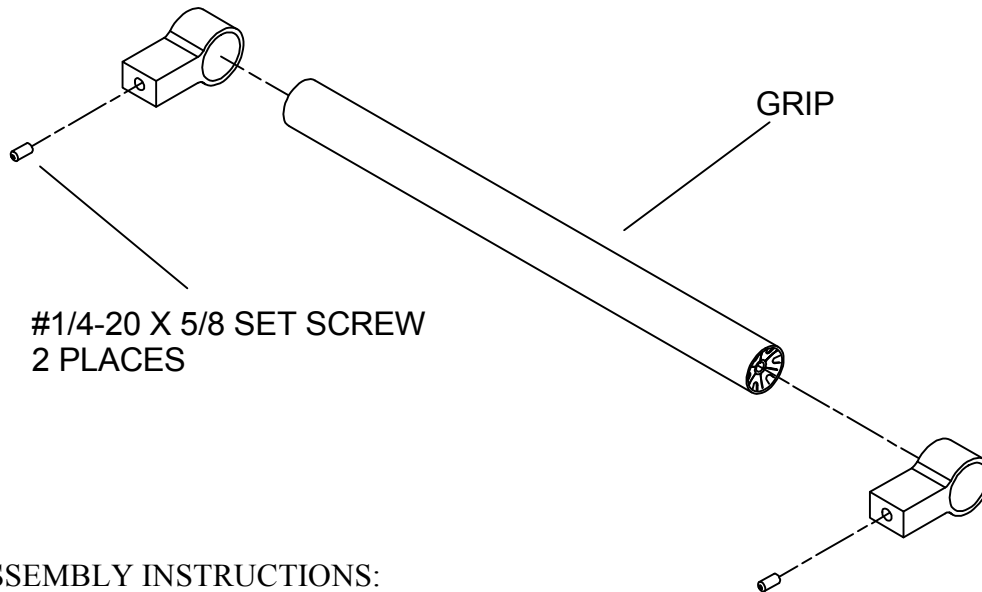

ASSEMBLY INSTRUCTIONS:

- 1) Locate and mark the center-to-center (CTC) distance of the 1185 assembly on the door - with attention to all applicable Codes.
- 2) Slide-on the Standoffs to the Grip Assy and position them such that the Standoffs are spaced from one another at the CTC distance, and such that the pair of Standoffs is centered on the Grip (i.e. the distance from each Standoff to the adjacent edge of the Grip is identical).
- 3) Place the 1185 Assembly against a flat surface, the bottoms of both Standoffs resting flush to this surface, then screw-in the provided 10-32 x 3/16" knurled cup point set screws into each Standoff using a hex (allen) wrench.
- 4) Installing these screws wet with a non-permanent, medium strength Threadlocker (such as Permatex 24250) will greatly enhance screw retention.

OFFSET STANDOFFS/GRIP/END CAPS ASSEMBLY

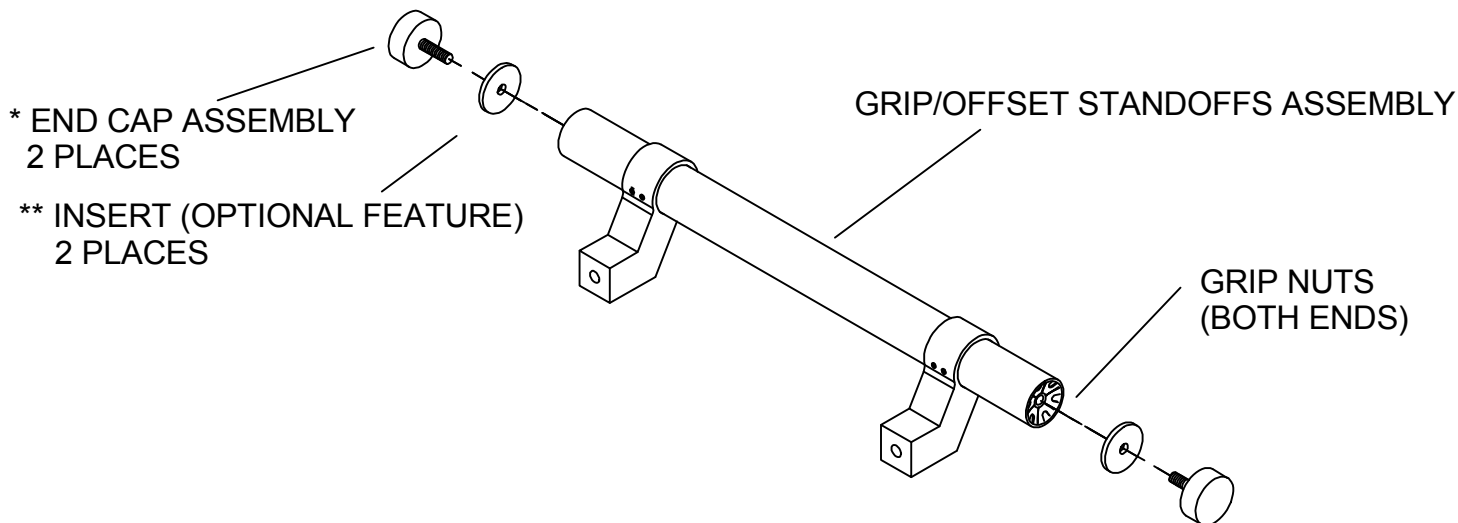

STRAIGHT STANDOFFS/GRIP/END CAPS ASSEMBLY

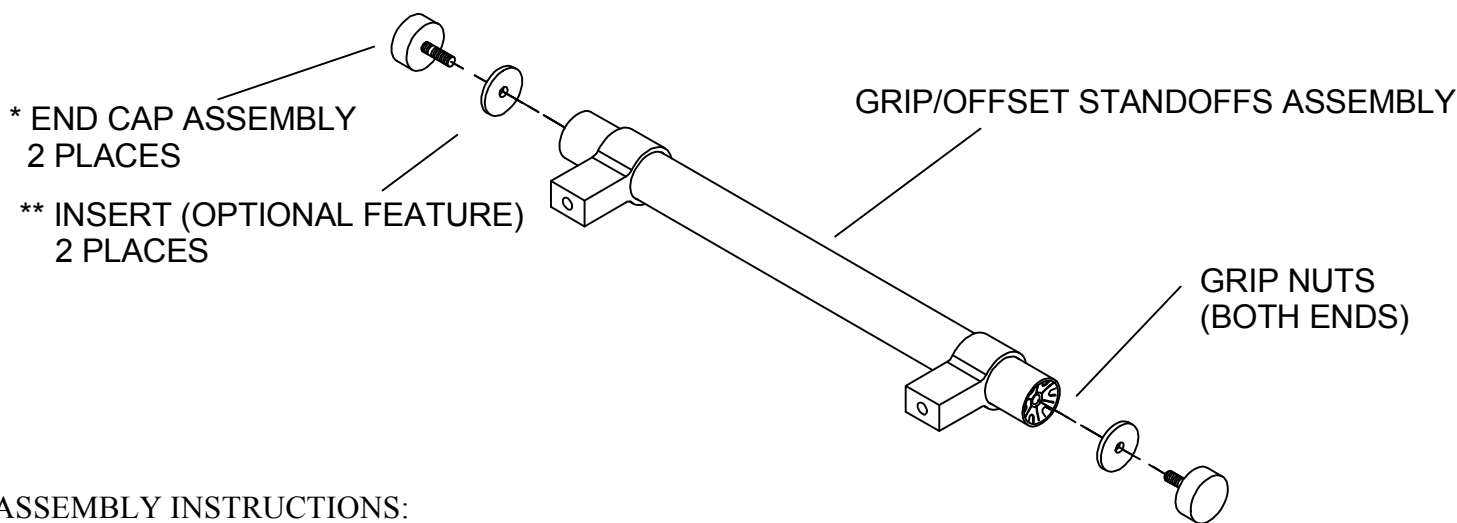

ASSEMBLY INSTRUCTIONS:

- 1) Guide the Insert (if an Insert is being used) over the threaded stud protruding from the End Cap - until it is flush with the End Cap.
- 2) Apply a non-permanent, medium strength Threadlocker (such as Permatex 24250) to the end of the End Cap threaded stud - this will greatly enhance End Cap retention. Insert the threaded stud of one End Cap into either of the Grip nuts and hand-tighten (no tool necessary). If desired, permanent Loctite or equivalent may alternatively be applied to the end of the End Cap threaded stud before it is inserted into the Grip nut to further enhance End Cap retention. Do not over-tighten.
- 3) Install the other End Cap (with an Insert if an Insert is being used) into the other end of the Grip in the same way as is described in Instructions 1 and 2 above.

* THIS END CAP IS AVAILABLE IN VARIOUS LENGTHS AND FINISHES

** AVAILABLE IN BLACK WHITE OR IN CUSTOM COLORS

1185 OFFSET STANDOFFS/GRIP ASSEMBLY

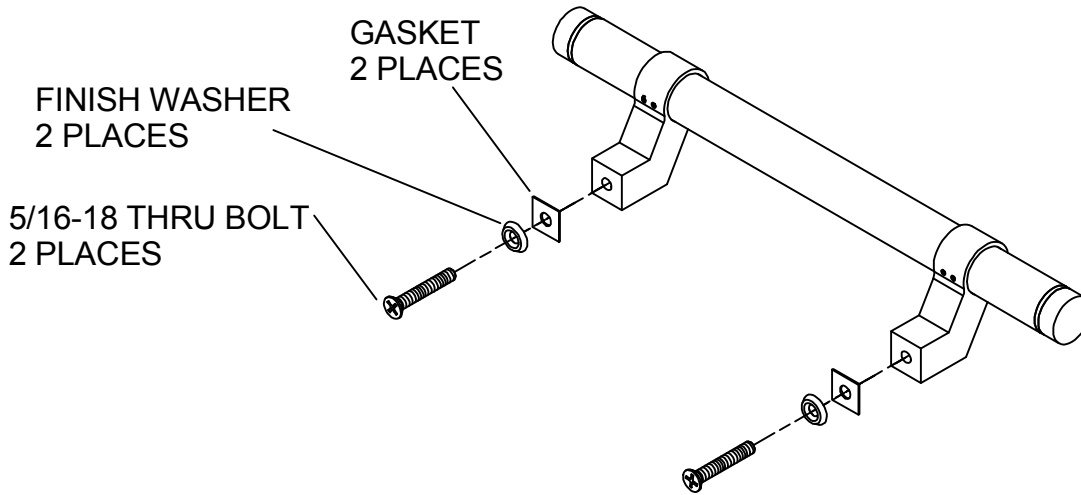

STANDARD INSTALLATION CONFIGURATION

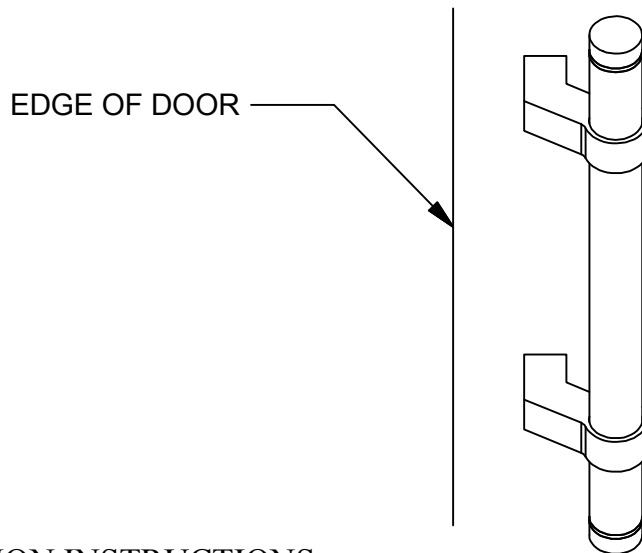

INSTALLATION INSTRUCTIONS:

- 1) Locate and mark the center-to-center (CTC) distance of the 1185 Assy being installed on the door - with attention to all applicable Codes. Drill 11/32" dia holes through the door at the marked locations.
- 2) Fit the finish washers onto the thru bolts, then slip the bolts through the 11/32" dia holes in the door from the interior side. On the exterior side, slide the Gaskets over the protruding ends of the thru bolts.
- 3) Align the threaded holes in the bottoms of the Standoffs with the protruding ends of the thru bolts, then tighten the bolts making sure that the Gaskets are clocked such that the Standoff legs will completely cover the Gaskets.

1185 STRAIGHT STANDOFFS/GRIP ASSEMBLY

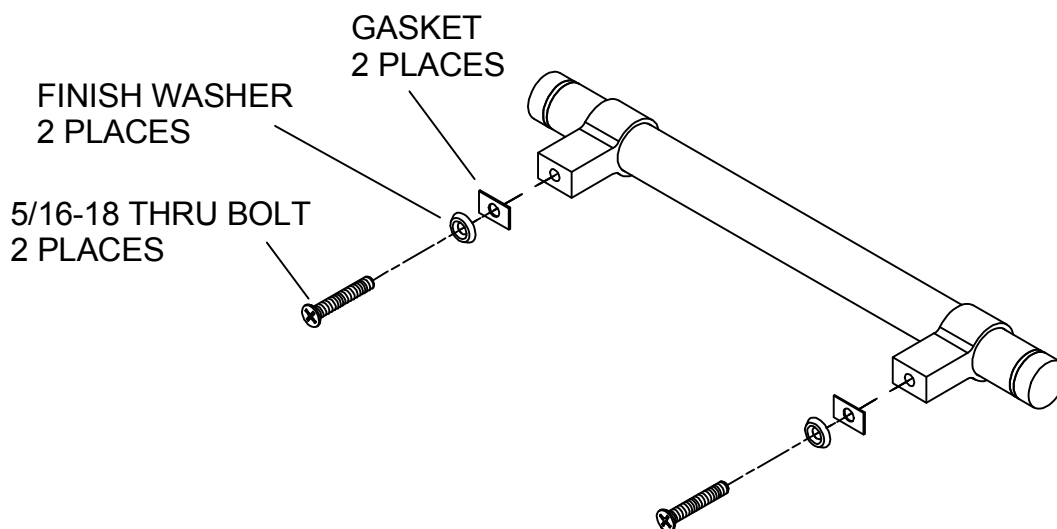

INSTALLATION INSTRUCTIONS:

- 1) Locate and mark the center-to-center (CTC) distance of the 1185 Assy being installed on the door - with attention to all applicable Codes. Drill 11/32" dia holes through the door at the marked locations.
- 2) Fit the finish washers onto the thru bolts, then slip the bolts through the 11/32" dia holes in the door from the interior side. On the exterior side, slide the Gaskets over the protruding ends of the thru bolts.
- 3) Align the threaded holes in the bottoms of the Standoffs with the protruding ends of the thru bolts, then tighten the bolts making sure that the Gaskets are clocked such that the Standoff legs will completely cover the Gaskets.