

**OFFSET STANDOFF/GRIP ASSEMBLY  
EXTERIOR**

2X #10-32 SET SCREW  
2 PLACES

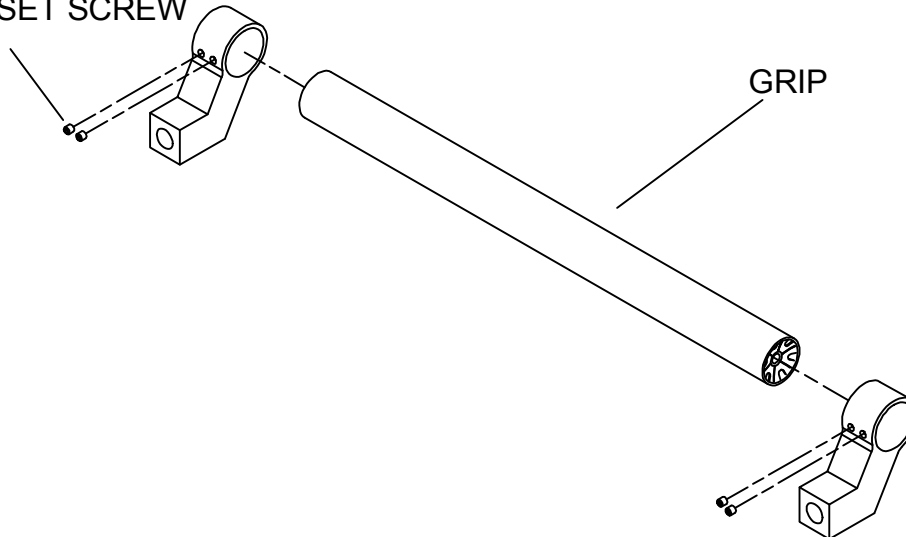

**OFFSET STANDOFF/GRIP ASSEMBLY  
INTERIOR**

2X #10-32 SET SCREW  
2 PLACES

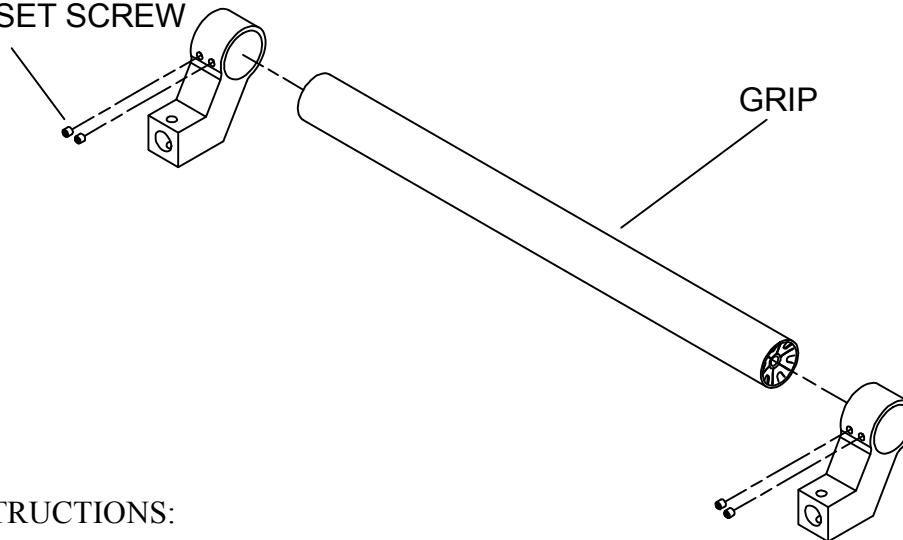

**CONFIGURATION GUIDE:**

**STEP-BY-STEP PULL ASSEMBLY:**

OFFSET STANDOFFS/GRIP  
ASSEMBLY: SHEET 1

STRAIGHT STANDOFFS/GRIP  
ASSEMBLY: SHEET 2

OFFSET STANDOFFS/GRIP/  
END CAP ASSEMBLY:  
SHEET 3

STRAIGHT STANDOFFS/GRIP/  
END CAP ASSEMBLY:  
SHEET 4

**FINAL INSTALLATION OF  
ASSEMBLED PULLS:**

1185 OFFSET STANDOFFS  
PULL ASSEMBLY: SHEET 5

1185 STRAIGHT STANDOFFS  
PULL ASSEMBLY: SHEET 6

**ASSEMBLY INSTRUCTIONS:**

- 1) Locate and mark the center-to-center (CTC) distance of the 1185 assembly on the door - with attention to all applicable Codes.
- 2) Slide-on the Standoffs to the Grip Assy and position them such that the Standoffs are spaced from one another at the CTC distance, and such that the pair of Standoffs is centered on the Grip (i.e. the distance from each Standoff to the adjacent edge of the Grip is identical).
- 3) Place the 1185 Assembly against a flat surface, the bottoms of both Standoffs resting flush to this surface, then screw-in the provided 10-32 x 3/16" knurled cup point set screws into each Standoff using a hex (allen) wrench.
- 4) Installing these screws wet with a non-permanent, medium strength Threadlocker (such as Permatex 24250) will greatly enhance screw retention.

REVISION: UPDATED STANDOFF PICTORIZATION  
04/19/16 SCCJG  
MOVED E-MOUNTING CONFIGURATION  
TO TEMPLATE 19837 06/01/16 SCCJG  
CORRECTED TYPE THREADLOCKER 3/20/17 SCC

**NOTE:** This template is provided for use only on the job for which is was requested. Trimco reserves the right to make design changes without notice. Trimco will not be responsible for errors or damage caused by the use of out-of-date templates.

**DATE**

**03/20/17**

**OFFSET STANDOFFS/GRIP/END CAPS ASSEMBLY  
EXTERIOR**

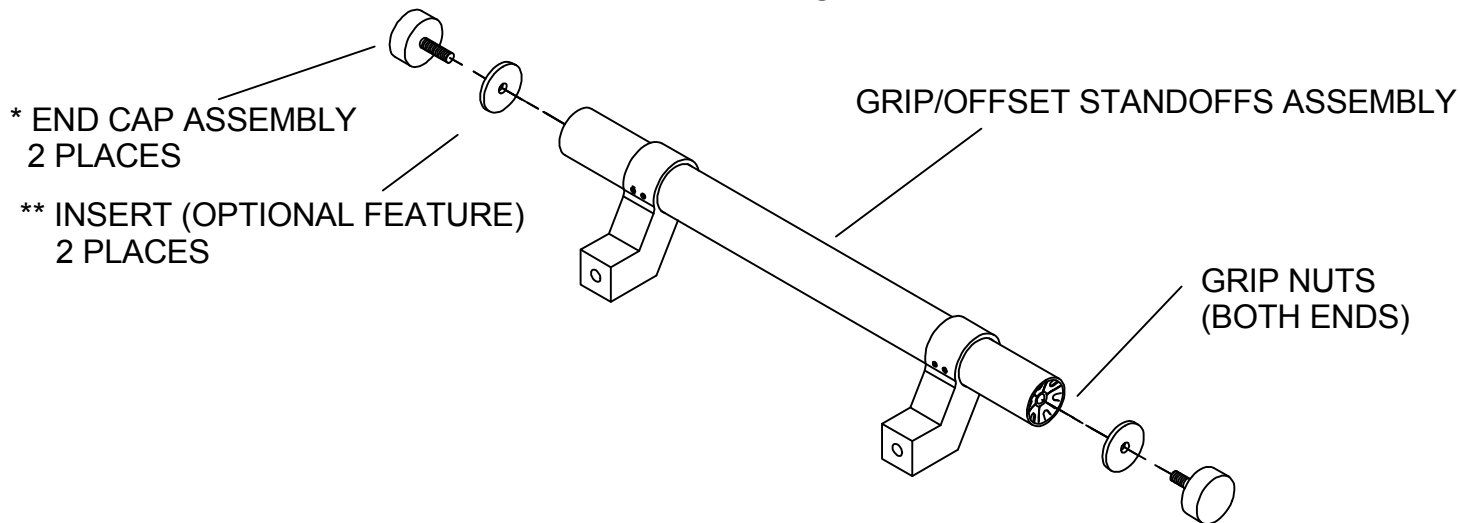

**OFFSET STANDOFFS/GRIP/END CAPS ASSEMBLY  
INTERIOR**

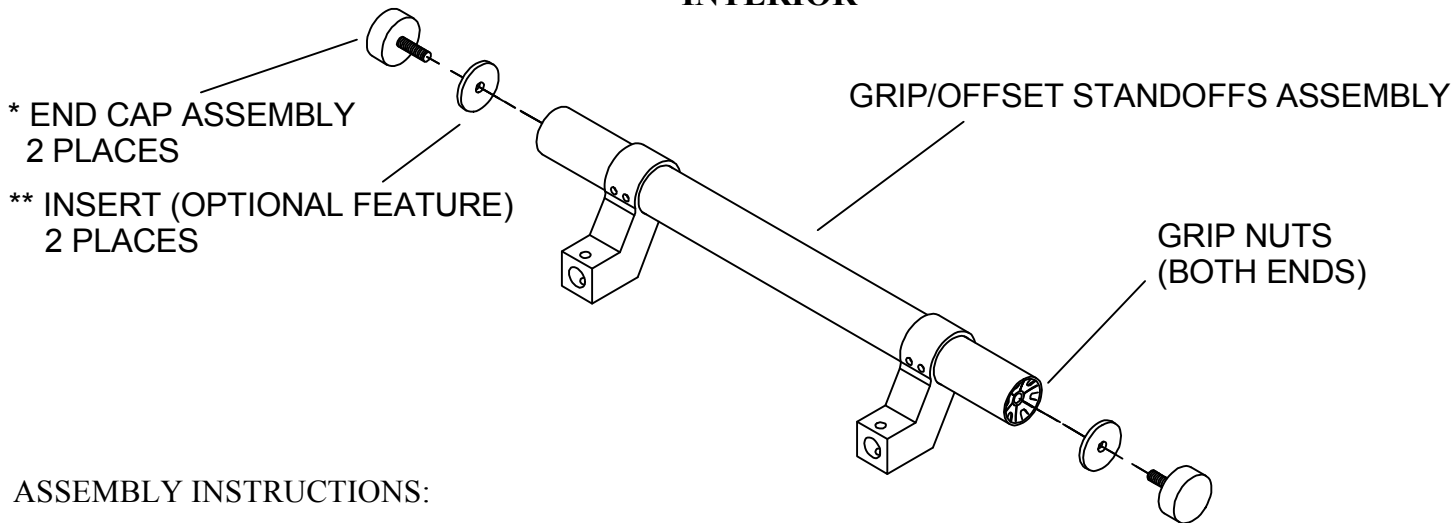

ASSEMBLY INSTRUCTIONS:

- 1) Guide the Insert (if an Insert is being used) over the threaded stud protruding from the End Cap - until it is flush with the End Cap.
- 2) Apply a non-permanent, medium strength Threadlocker (such as Permatex 24250) to the end of the End Cap threaded stud - this will greatly enhance End Cap retention. Insert the threaded stud of one End Cap into either of the Grip nuts and hand-tighten (no tool necessary). If desired, permanent Loctite or equivalent may alternatively be applied to the end of the End Cap threaded stud before it is inserted into the Grip nut to further enhance End Cap retention. Do not over-tighten.
- 3) Install the other End Cap (with an Insert if an Insert is being used) into the other end of the Grip in the same way as is described in Instructions 1 and 2 above.

\* THIS END CAP IS AVAILABLE IN VARIOUS LENGTHS AND FINISHES

\*\* AVAILABLE IN BLACK WHITE OR IN CUSTOM COLORS

**STRAIGHT STANDOFF/GRIP ASSEMBLY**  
**EXTERIOR**

#1/4-20 X 5/8 SET SCREW  
2 PLACES

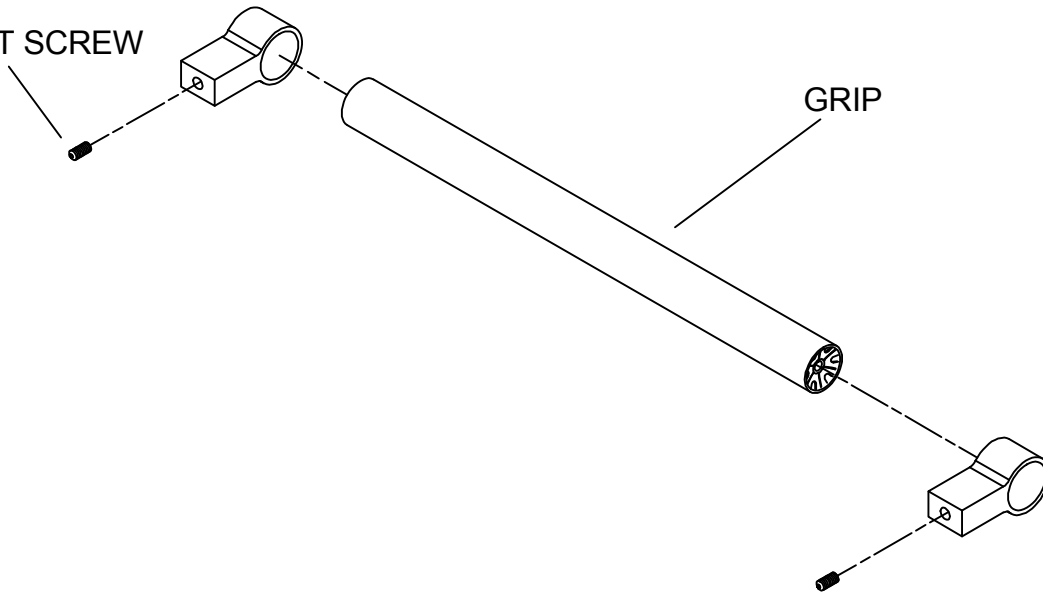

**STRAIGHT STANDOFF/GRIP ASSEMBLY**  
**INTERIOR**

#1/4-20 X 5/8 SET SCREW  
2 PLACES

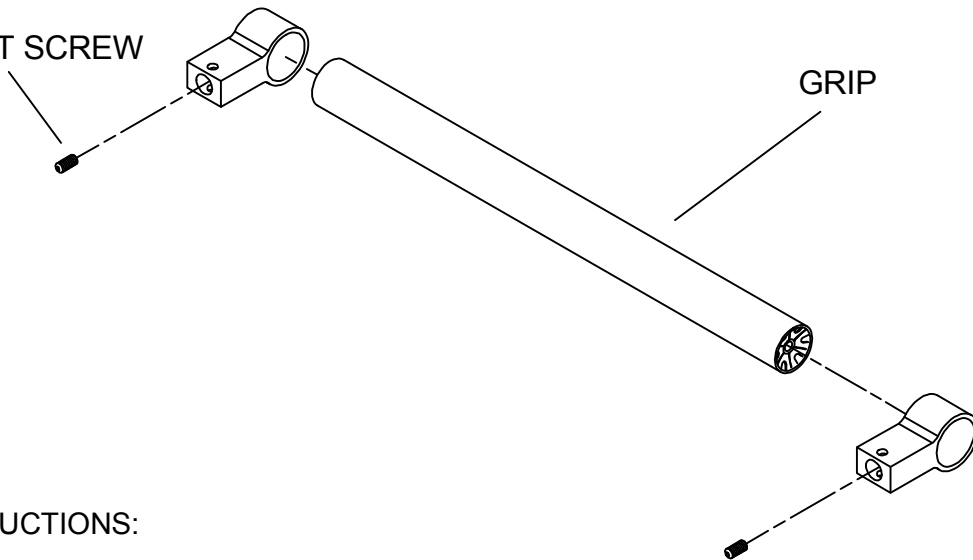

**ASSEMBLY INSTRUCTIONS:**

- 1) Locate and mark the center-to-center (CTC) distance of the 1185 assembly on the door - with attention to all applicable Codes.
- 2) Slide-on the Standoffs to the Grip Assy and position them such that the Standoffs are spaced from one another at the CTC distance, and such that the pair of Standoffs is centered on the Grip (i.e. the distance from each Standoff to the adjacent edge of the Grip is identical).
- 3) Place the 1185 Assembly on a table or other surface, then screw-in the provided 1/4-20 x 5/8" set screws into each Standoff using a hex (allen) wrench. Installing these screws wet with a non-permanent, medium strength Threadlocker (such as Permatex 24250) will greatly enhance screw retention. It is recommended that both set screws be snug-tightened before either is fully tightened.

**STRAIGHT STANDOFFS/GRIP/END CAPS ASSEMBLY  
EXTERIOR**

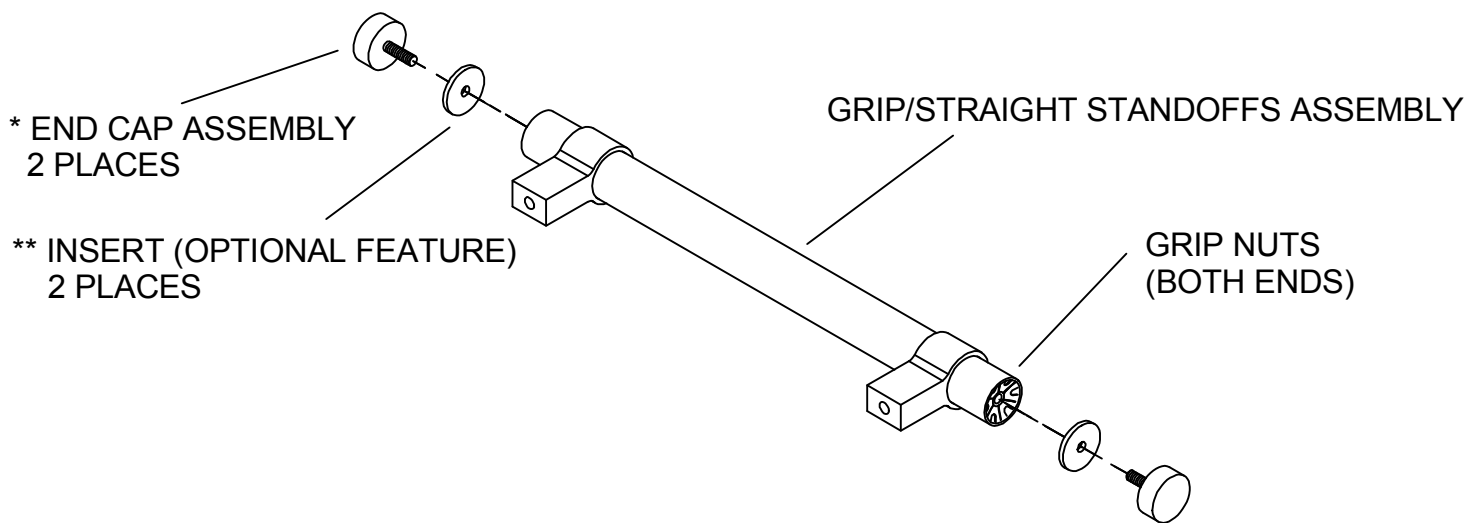

**STRAIGHT STANDOFFS/GRIP/END CAPS ASSEMBLY  
INTERIOR**

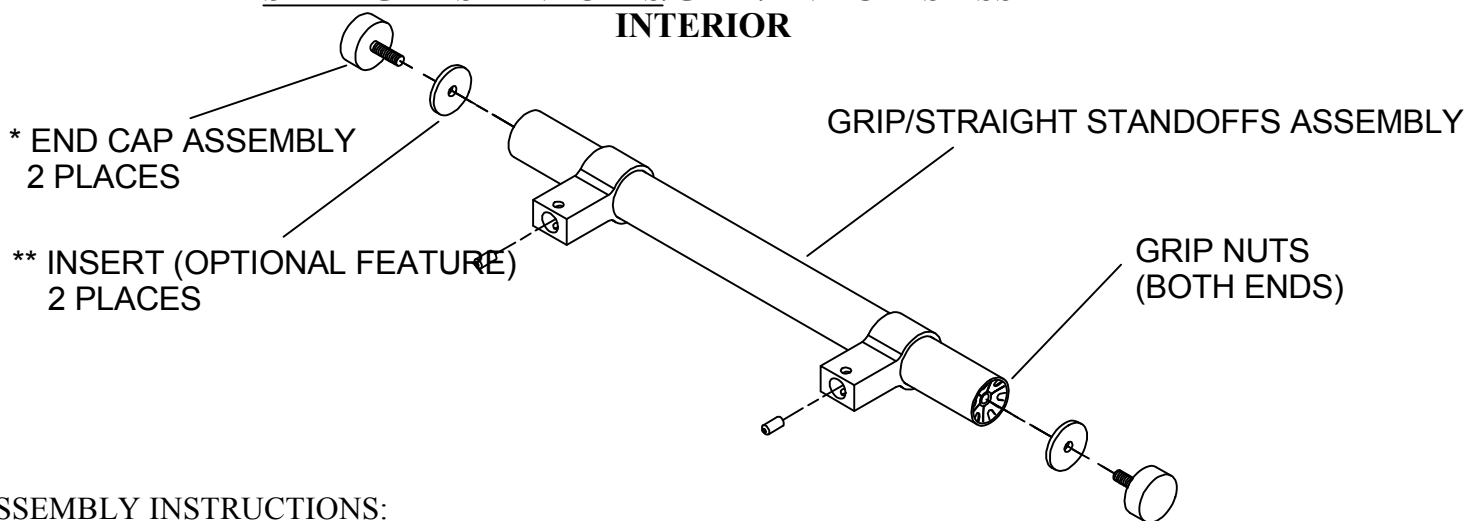

ASSEMBLY INSTRUCTIONS:

- 1) Guide the Insert (if an Insert is being used) over the threaded stud protruding from the End Cap - until it is flush with the End Cap.
- 2) Apply a non-permanent, medium strength Threadlocker (such as Permatex 24250) to the end of the End Cap threaded stud - this will greatly enhance End Cap retention. Insert the threaded stud of one End Cap into either of the Grip nuts and hand-tighten (no tool necessary). If desired, permanent Loctite or equivalent may alternatively be applied to the end of the End Cap threaded stud before it is inserted into the Grip nut to further enhance End Cap retention. Do not over-tighten.
- 3) Install the other End Cap (with an Insert if an Insert is being used) into the other end of the Grip in the same way as is described in Instructions 1 and 2 above.

\* THIS END CAP IS AVAILABLE IN VARIOUS LENGTHS AND FINISHES

\*\* AVAILABLE IN BLACK WHITE OR IN CUSTOM COLORS

**1185 OFFSET STANDOFFS PULL ASSEMBLY**

**STANDARD INSTALLATION CONFIGURATION**

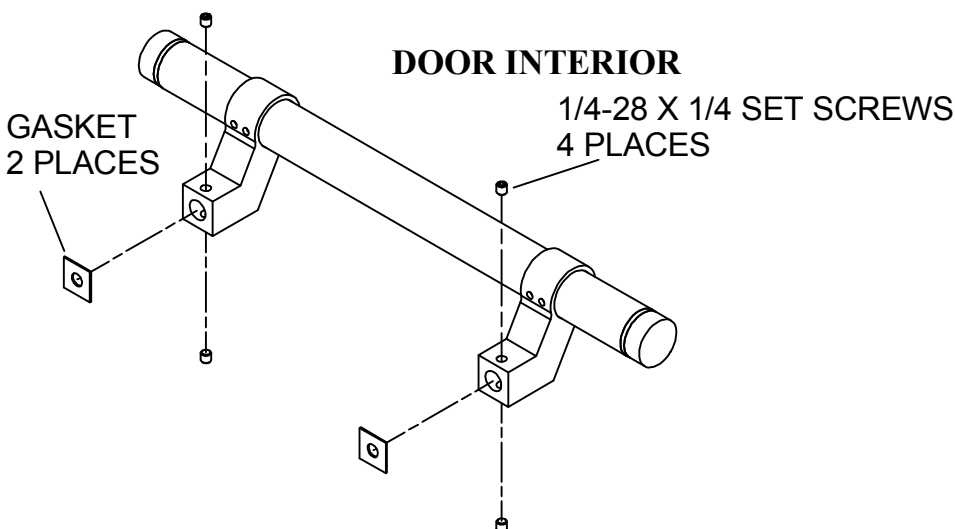
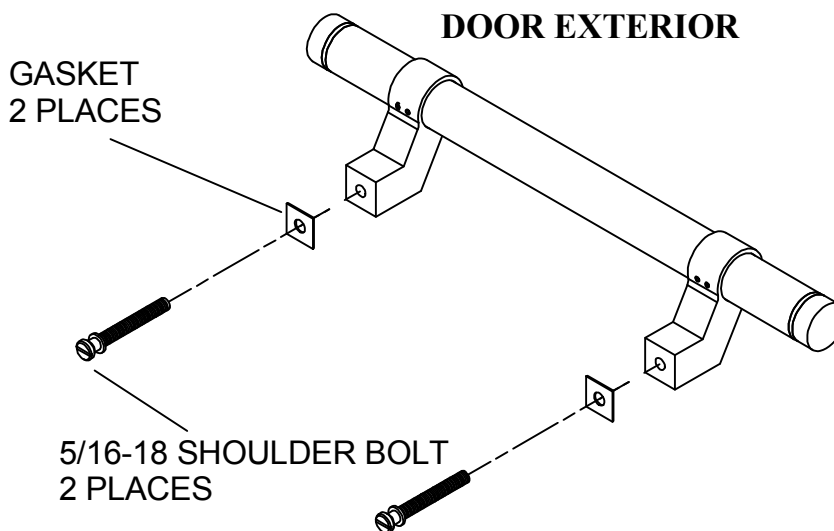
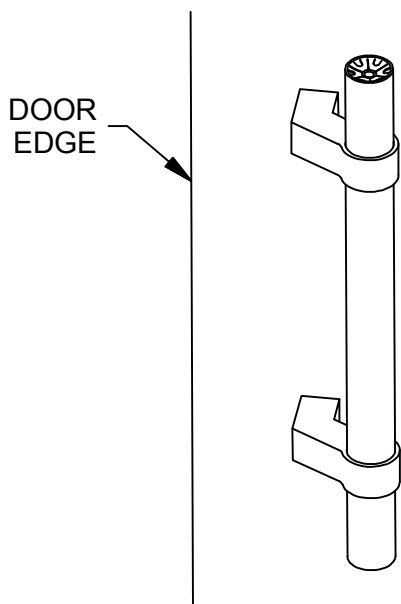

**INSTALLATION INSTRUCTIONS:**

- 1) Locate and mark the center-to-center (CTC) distance of the 1185 Assy being installed on the door - with attention to all applicable Codes. Drill 11/32" dia holes through the door at the marked locations.
- 2) Fit a Gasket onto each shoulder bolt, then slip the bolts through the 11/32" dia holes in the door from the interior side. On the exterior side, slide the remaining two Gaskets over the protruding threaded ends of the shoulder bolts.
- 3) Align the threaded holes in the bases of the Standoffs of the external 1185 Assy with the protruding ends of the shoulder bolts, then tighten the bolts making sure that the Gaskets - on both sides of the door - are aligned (clocked) such that the Standoff legs will completely cover the Gaskets.
- 4) Fit the counter-bored holes in the bases of the Standoffs of the internal 1185 Assy over the heads of the shoulder bolts, then thread-in and tighten the 1/4-28 set-screws using a hex (allen) wrench. Installing these screws wet with a non-permanent, medium strength Threadlocker (such as Permatex 24250) will greatly enhance screw retention.

**1185 STRAIGHT STANDOFFS PULL ASSEMBLY**

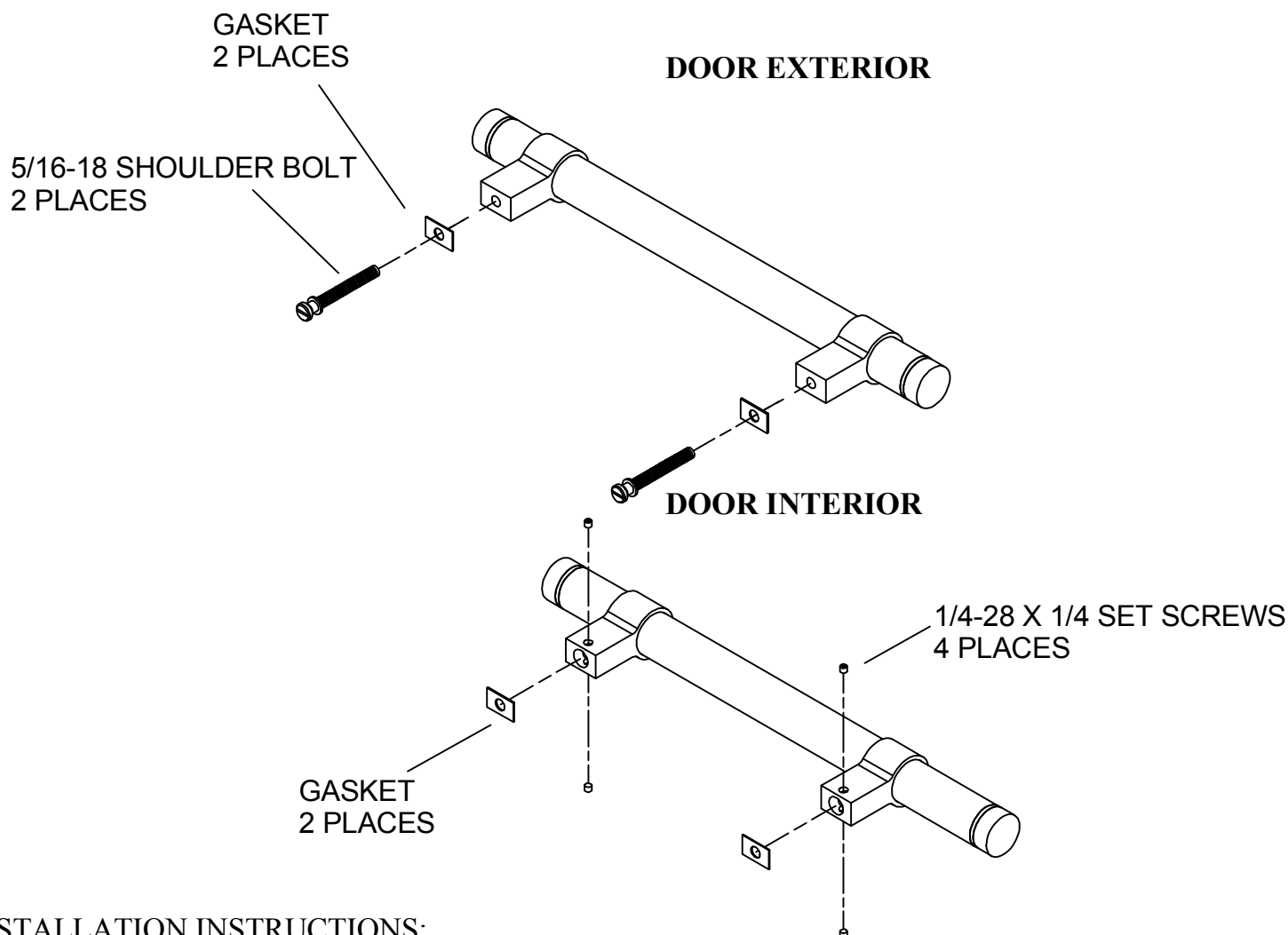

**INSTALLATION INSTRUCTIONS:**

- 1) Locate and mark the center-to-center (CTC) distance of the 1185 Assy being installed on the door - with attention to all applicable Codes. Drill 11/32" dia holes through the door at the marked locations.
- 2) Fit a Gasket onto each shoulder bolt, then slip the bolts through the 11/32" dia holes in the door from the interior side. On the exterior side, slide the remaining two Gaskets over the protruding threaded ends of the shoulder bolts.
- 3) Align the threaded holes in the bases of the Standoffs of the external 1185 Assy with the protruding ends of the shoulder bolts, then tighten the bolts making sure that the Gaskets - on both sides of the door - are aligned (clocked) such that the Standoff legs will completely cover the Gaskets.
- 4) Fit the counter-bored holes in the bases of the Standoffs of the internal 1185 Assy over the heads of the shoulder bolts, then thread-in and tighten the 1/4-28 set-screws using a hex (allen) wrench. Installing these screws wet with a non-permanent, medium strength Threadlocker (such as Permatex 24250) will greatly enhance screw retention.