

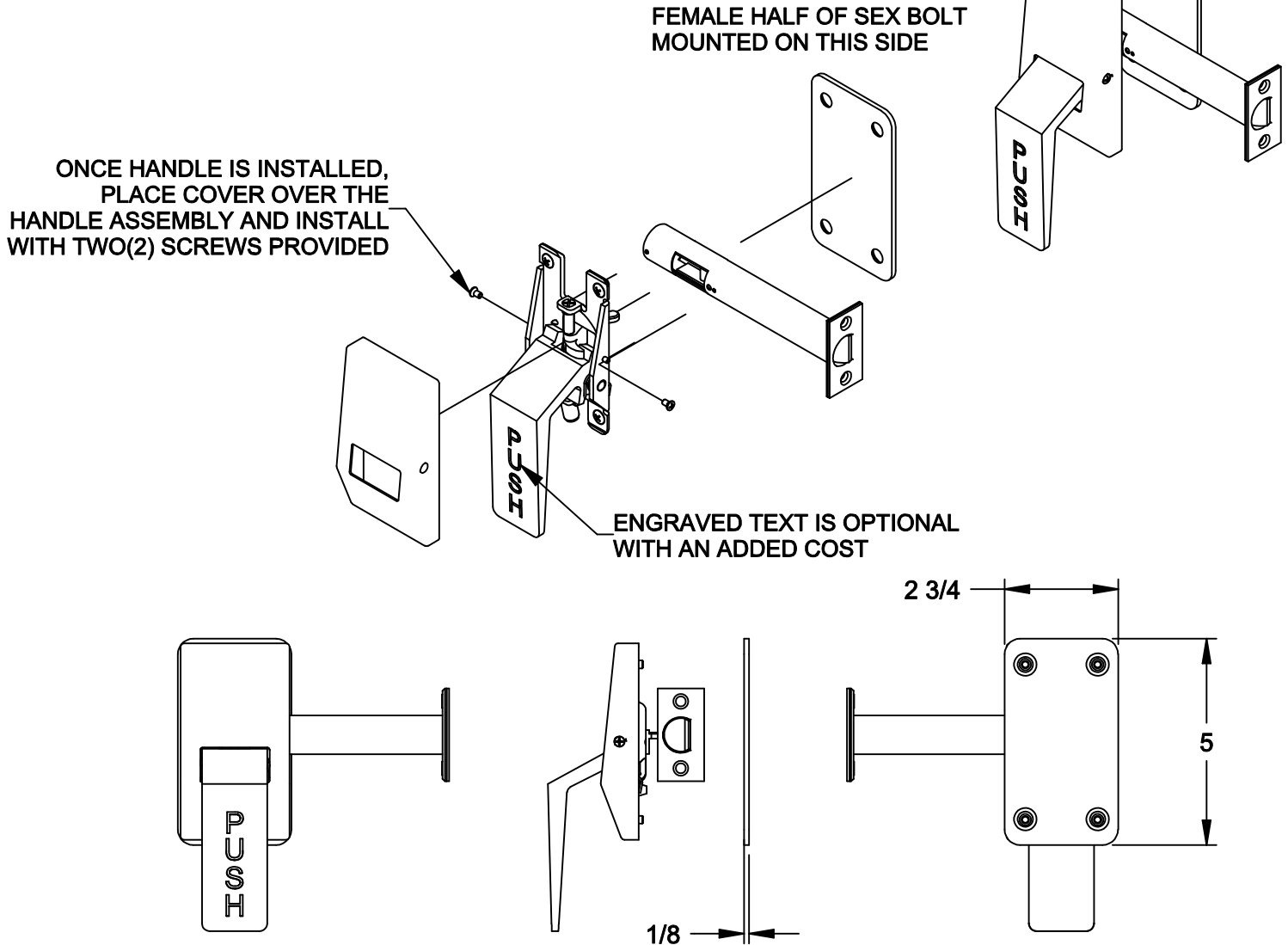

ADA AND UL COMPLIANT



SUPPLIED WITH FOUR (4) 1/4-20 SEX BOLTS FOR MOUNTING HANDLE AND PLATE -
DOOR PREP FOR SEX BOLT - DRILL Ø5/16 HOLES. ALSO SUPPLIED WITH TWO (2) #8 X 3/4
COMBO SCREWS FOR MOUNTING THE LATCHBOLT.

SPECIFY HANDING, BACKSET AND STRIKE WHEN ORDERING.
ILLUSTRATION SHOWN IS LEFT HAND PUSH LEVER WITH A 5" BACKSET LATCHBOLT.

FOR OUT-SWINGING DOORS USE PUSH LEVER
FOR IN-SWINGING DOORS USE PULL LEVER

NOTE: This template is provided for use only on the job for which is was requested.
Trimco reserves the right to make design changes without notice. Trimco will
not be responsible for errors or damage caused by the use of out-of-date templates.

DATE

6/11/08